

## Create New Homepage

*Adding The Learning Center Widget*



To add the Learning Center widget to your course homepage, a new homepage must be created. Follow the instructions below to add the widget.

Access the Course

Choose **Edit Course**

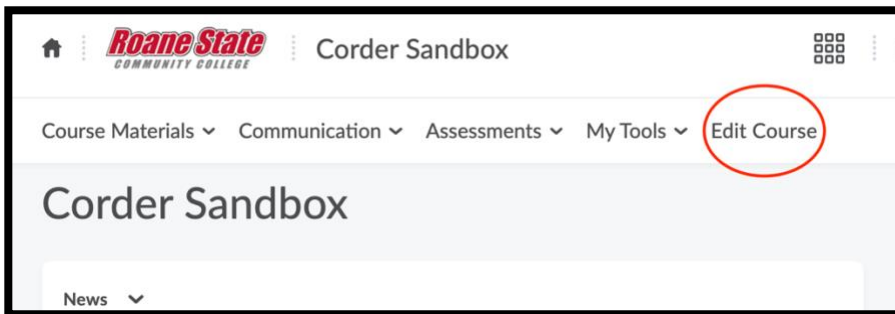

*Edit Course 1*

Choose **Homepages**

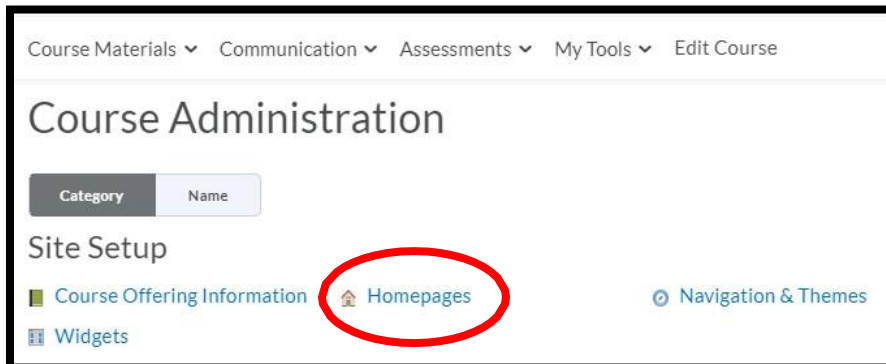

*Choose Homepage 1*

## Choose **Create Homepage**

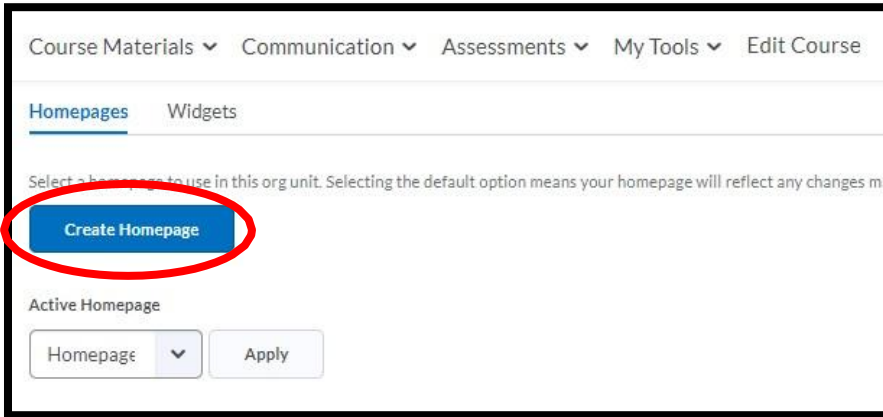

Course Materials ▾ Communication ▾ Assessments ▾ My Tools ▾ Edit Course

Homepages Widgets

Select a homepage to use in this org unit. Selecting the default option means your homepage will reflect any changes made to the default homepage.

**Create Homepage**

Active Homepage

Homepage ▾ Apply

*Create Homepage 1*

Create a **Name** for new homepage (description is optional).



# Create Homepage

Name \*

Homepage Name

Description

*Create Homepage Name 1*

Other layout options may be changed as needed.

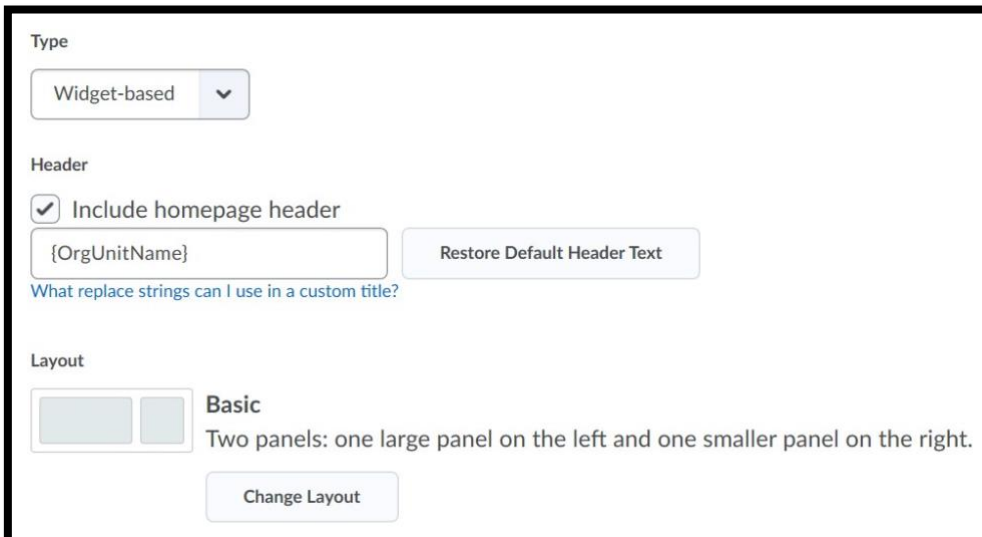

Type

Widget-based ▾

Header

Include homepage header

{OrgUnitName} Restore Default Header Text

What replace strings can I use in a custom title?

Layout

Basic

Two panels: one large panel on the left and one smaller panel on the right.

Change Layout

*Other Layout Options 1*

Scroll to bottom of page to **Add Widgets**.



*Add Widgets 1*

Place a **check** beside **The Learning Center** widget to add it to the page, then click **Add**. Do this for both sides of the template if needed.

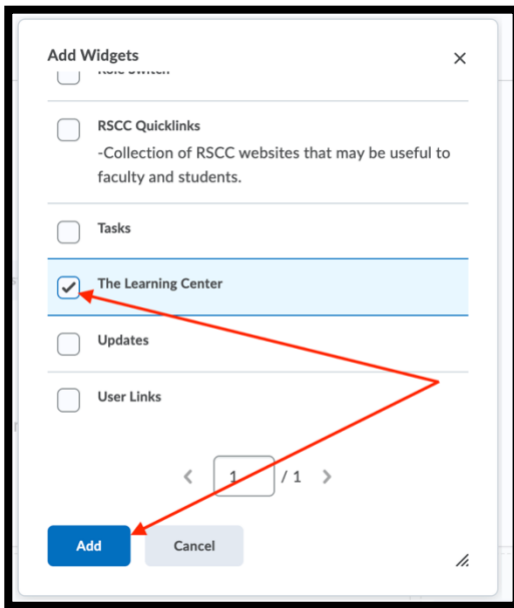

*Choose Widget 1*

Preview the layout/content of the new homepage. Items can be rearranged as needed. Click **Save and Close**.

To choose the new homepage, click the drop menu under **Active Homepage**.

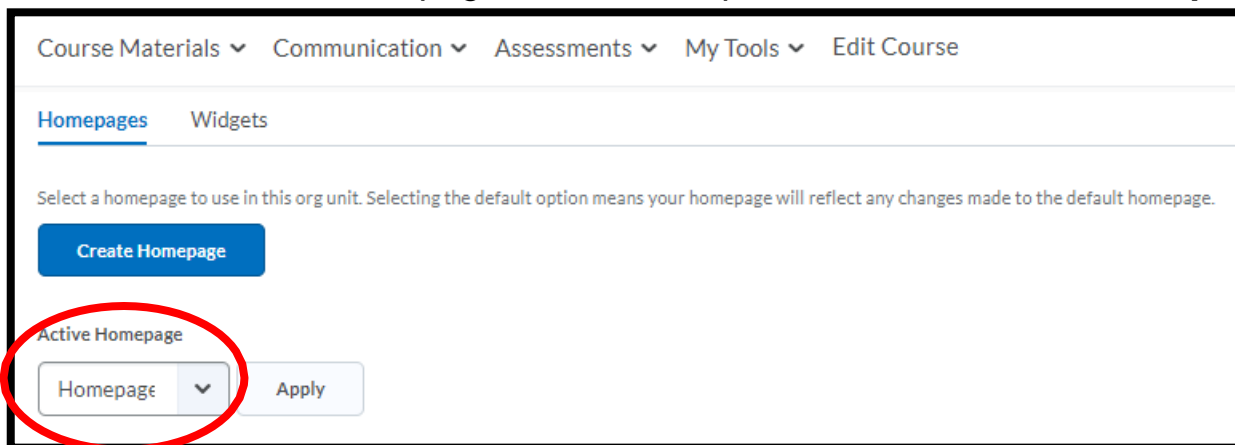

Choose the new homepage title, then **Apply**.

Select a homepage to use in this org unit. Selecting the default option

Create Homepage

- Default --
- Course Homepage
- ✓ Course Homepage - Ask a librarian Widget
- Course Homepage - WCONLINE
- My Home Homepage

Course Homepage ▾

*Apply Homepage 1*

The new homepage will show as **Active**.

Homepage with Pearson Widget ▾

✓ Active  
Not shared

*Shows Active 1*

Return to the live course homepage to check the layout and content.

If changes need to be made, return to **Edit Course/Widgets/Homepages**. Click on the title of the homepage to edit content.

When editing is complete, click **Save and Close**.